

ONLY
ONE SPACE
LEFT!

BENNETT HILLS SHOPPING CENTER

10037-10091 MANCHESTER ROAD

ST. LOUIS, MO 63122

RETAIL SPACE FOR LEASE

Suite 10049: 4,094 sf
Last remaining unit!

\$13.00 PSF
(Triple Net Lease)



PROPERTY HIGHLIGHTS

- Excellent location for a variety of retail or service-related businesses
- High volume traffic - 46,000+ cars daily
- In Warson Woods - surrounded by Kirkwood, Glendale, & Ladue
- Easy access to major highways
- Competitive leasing rates
- Charter service available



VIEW BROCHURE

For more information or to arrange a tour, please contact:

Sharon Botkin **314-542-0777**
sbotkin@scottproperties.com

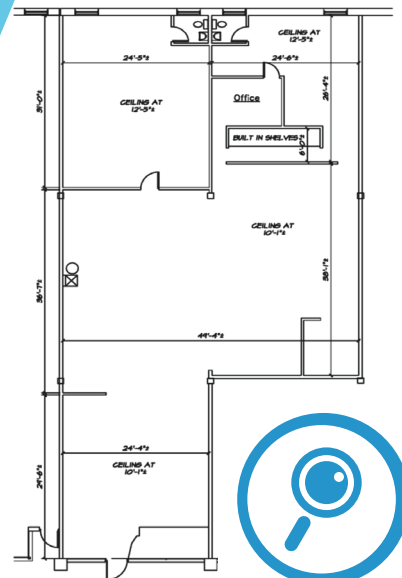

VIEW FLOORPLAN



www.scottproperties.com

1065 EXECUTIVE PARKWAY • SUITE 300 • ST. LOUIS, MO 63141